

DIRECTORY SIGN LOCATION

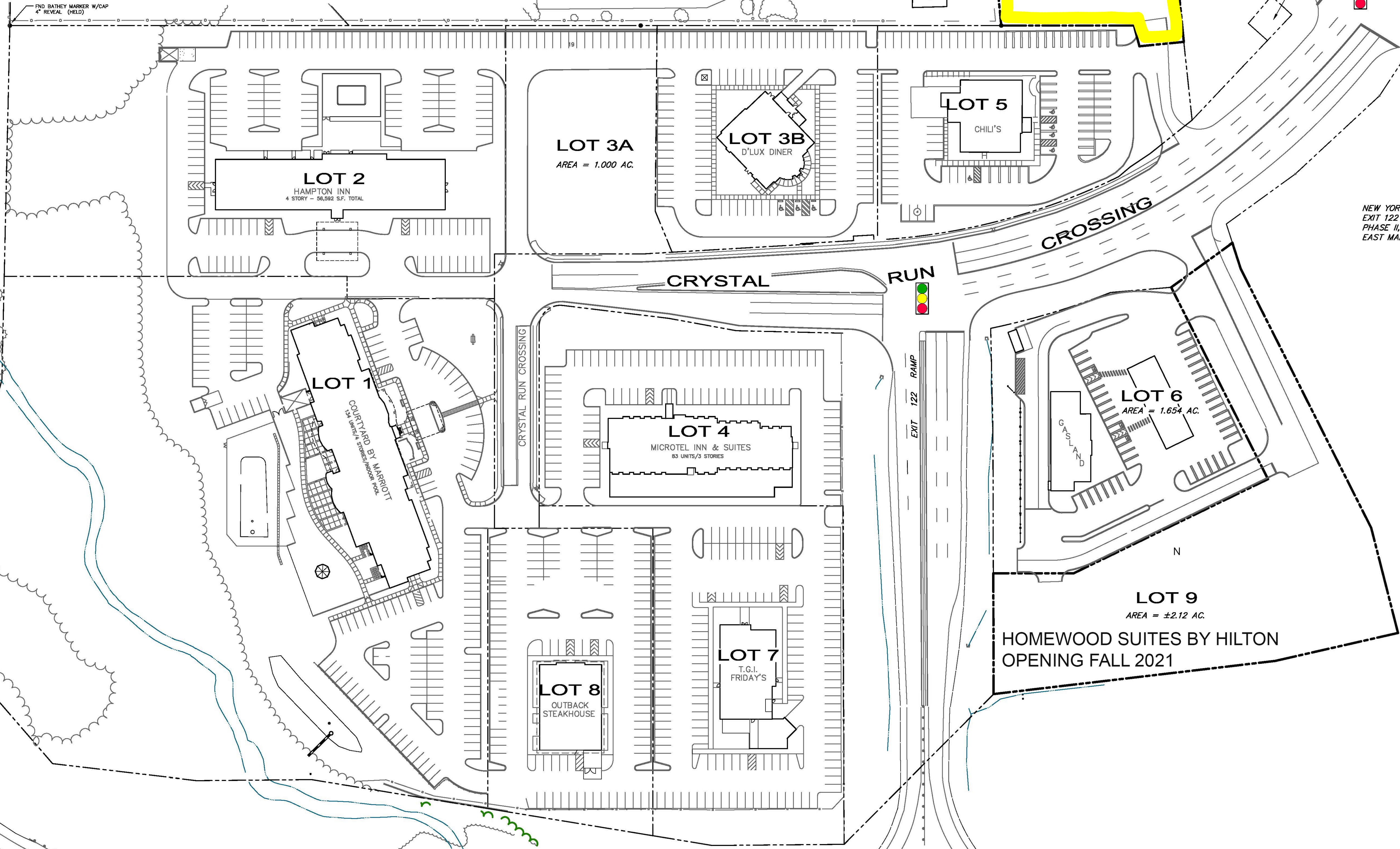

INTERSTATE HIGHWAY ROUTE 84



NEW YORK STATE DEPARTMENT OF TRANSPORTATION
 EXIT 122 PROPOSED INTERCHANGE IMPROVEMENTS
 PHASE II, RELOCATION OF CRYSTAL RUN ROAD AND
 EAST MAIN STREET

NEW YORK STATE HIGHWAY ROUTE 17



(EASTBOUND) TO GOSHEN

RAMP "K" FROM INTERSTATE 84

CRYSTAL RUN CROSSING
 MIDDLETOWN NEW YORK